



## NEWS RELEASE

**HIGH GRADE ZONE DEEPER, WIDER AND RICHER  
10.80 OUNCES PER TON GOLD OVER 70 FEET!  
ENCOURAGING RESULTS IN FAR EAST - 1.84 OZ/T AU OVER 26 FT.  
SULPHIDES CONTINUE AT DEPTH – 1.98 OZ/T OVER 7 FT.  
(All dollar amounts in US\$)**

Toronto, September 6, 2002, GOLDCORP INC. (GG:NYSE; G:TSX) is pleased to announce continuing exploration success at its Red Lake Mine. The highlights of the most recent exploration results are summarized below.

- The **High Grade Zone (HGZ)** appears to be widening at depth. The deepest and richest intersection encountered was **10.80 ounces of gold per ton (opt) (370.3 grams per tonne (gpt)) over 70 ft (21.34 m)** at a vertical depth of 6850 ft (2088 m). It was within a **338 feet (ft) (103 metres (m)) interval containing 10 zones of gold mineralization.**
- Drilling (Delineation and Definition) within and immediately around the HGZ designed to upgrade resources to reserves and increase total resources, has produced good results. There were **51 intersections** of high grade gold with an average grade of **8.34 opt (286 gpt) over an average thickness of 6.1 ft (1.86 m).**
- The most significant new intersection from the Far East Zone was **1.84 opt (63.0 gpt) over 26 ft (7.92 m)** at a vertical depth of 5950 ft (1814 m).
- The continuity of the sulphide mineralization continues to be confirmed. Drilling below the limits of previous mining encountered generally lower grade intersections over widths up to 21 feet. However, the highlight was an intersection of **1.98 opt (67.9 gpt) over 7.0 ft (2.13 m)** that appears to align with our Western Complex structural model.

### FOUR TARGET AREAS

Goldcorp is currently conducting its largest exploration program ever at the Red Lake Mine. The goal of this work is to substantially expand reserves and resources to a level sufficient to increase mine life and expanded gold production. The exploration program is focused on four areas, which are: **1) Depth extensions of the High Grade Zone (HGZ)** from which all current production takes place; **2) depth extensions of the sulphide mineralization**, which was the source of all production from 1948 to 1996; **3) a potential repeat sequence of Red Lake Mine style mineralization to the east in the Far East Zone;** and **4) potential high grade mineralization west of the HGZ in what is called the Western Complex Area.**

## CONFIRMATION OF EXPLORATION MODEL

**The results obtained during 2002 continue to confirm the validity of our exploration model** which is based on observations that the high grade mineralization at both the Red Lake Mine itself and the adjacent Campbell Mine is controlled by distinct linear structures. **More than 75% of all the gold discovered at the Red Lake Mine occurs along, or adjacent to, such a structure.** We believe more gold will be discovered along extensions of this known structure and along additional parallel linear structure in the Far East Zone and Western Complex Area.

## DEPTH EXTENSIONS OF HIGH GRADE ZONE (HGZ)

Hole 37L032AW intersected **ten (10) zones** of gold mineralization within a **338 ft (103m) interval**. Among these, three were particularly noteworthy **including 10.80 opt (370.3 gpt) over 70 ft (21.34 m), 1.85 opt (63.4 gpt) over 4 ft (1.22 m), and 0.89 opt (30.5 gpt) over 12.0 ft (3.66 m)**. This is the highest grade, deepest intersection obtained, to date, at a **vertical depth of 6850 ft (2088 m)**. This hole was completed as a wedge (or second intersection) off hole 37L032. It was the first hole where multiple zones of mineralization had been reported below the current limit of resources (29/05/02).

While the intersections in the most recent hole (37L032AW) are only a short distance (10 ft or 3.05 m) from this first hole, these results are significant for two principal reasons. Firstly, they confirm the results from hole 37L032 and therefore the occurrence of potentially continuous multiple zones of high grade mineralization at depth. In addition they demonstrate that the extremely high grade nature of this zone is continuous at depth.

A further particularly encouraging development is that depth extensions of other zones of mineralization within the HGZ have also been identified 1500 ft (457 m) further to the east of the Hanging Wall 5 Zone, with results including **0.76 opt (26.1 gpt) over 3.3 ft (1.01 m) and 0.62 opt (21.3 gpt) over 3.0 ft (0.91 m)** both in hole 34L1054, together with **0.62 opt (21.3 gpt) over 5.0 ft (1.52 m) in hole 34L1053**. These intersections are extensions of what are called the **Footwall (FW) Zones** within the HGZ and their style and grade are representative of these zones elsewhere in the mine. This mineralization was intersected down to a **vertical depth of 6500 ft (1981 m)**, approximately **1000 ft (305 m) vertically below** the current limit of reserves in these zones.

## Delineation Drilling Confirms continuity of High Grade Zone at depth

Drilling below the 37 Level (5550 ft or 1692 m below surface) has obtained **51 intersections** of high grade mineralization with an average grade of **8.34 opt (286 gpt) over an average of 6.1 ft (1.86 m)**. Some of the more significant intersections include **57.83 opt (1982.7 gpt) over 5.7 ft (1.74 m)** in hole 37L307, **50.29 opt (1724.2 gpt) over 4.5 ft (1.37 m)** in hole 37L232, and **36.69 opt (1257.9 gpt) over 8.0 ft (2.44 m)** in hole 37L247.

## **FAR EAST ZONE**

### **Intersections up to 1.84 opt (63.0 gpt) over 26 ft (7.92 m).**

The Far East Zone has the potential to host another Red Lake Mine. The exploration model suggests that gold mineralization in this area could be controlled by two (or more) parallel linear structures. The first is the upward projection of the structure hosting the HGZ, and the second is interpreted to be to the east and parallel to this first structure. Since the last exploration update this zone has been drilled both from underground locations, 16 Level (2400 ft or 732 m below surface) and the 34 Level (5000 ft or 1525 m below surface) and from surface.

### **Underground Drilling – Results are Encouraging**

Drilling from the 16 Level targeted the upward projection of the structure hosting the HGZ. The most impressive intersections were **0.34 opt (11.7 gpt) over 37.5 ft (11.43 m)**, including **1.06 opt (36.3 gpt) over 2.5 ft (0.76 m)** in hole 16L1188, in addition to **0.41 opt (14.1 gpt) over 15.0 ft (4.57 m)** in hole 16L1175. The fact that gold mineralization was encountered over substantial widths and that some holes encountered multiple zones of mineralization is particularly encouraging.

Drilling from the 34 Level targeted the projection at depth of the second structural trend which is interpreted to occur in the Far East Zone. The latest results provided increased confidence in that interpretation and in the continuity of mineralization in that area. Some of the more significant intersections included **1.84 opt (63.0 gpt) over 26 ft (7.92 m)** in hole 34L1086, together with **0.69 opt (23.7 gpt) over 5.0 ft (1.52 m)** and **0.43 opt (14.7 gpt) over 4.9 ft (1.49 m)** both in hole 34L1085. This work was able to test the Far East Zone over a vertical distance of 1200 ft (366 m) and a lateral distance of 400 ft (122 m). Again the occurrence of multiple intersections in one hole is a good sign.

## **DEPTH EXTENSIONS OF SULPHIDE MINERALIZATION**

The latest exploration results continue to confirm the continuity of this mineralization to depth. The grade of intersections varied from 0.10 opt (3.4 gpt) to 1.98 opt (67.9 gpt) over widths from 1.5 ft (0.46 m) to 21 ft (6.4 m). The highlight was **1.98 opt (67.9 gpt) over 7.0 ft (2.13 m)** in hole 34L1018, which appears to align with our Western Complex structural model.

This mineralization has previously been encountered in isolated drill holes to a vertical depth of 7200 ft (2195 m) suggesting the possibility that it is indeed continuous to greater depths. The current exploration program has focused on establishing continuity of the sulphide below previously mined areas.

**Sulphide mineralization** was the sole source of production at the Red Lake Mine from 1948 to 1996 contributing 3.2 million ounces of gold to a vertical depth of 4400 ft (1341 m). This mineralization is typically lower grade than the HGZ. However, should this mineralization be continuous to the same depths as the HGZ (at least 6850 ft or 2088 m) it would provide a substantial increase in reserves and a valuable source of additional production.

**QUALIFIED PERSON**

These results have been prepared under the guidance of Gilles Filion, P.Eng. (OIQ), Vice President of Exploration, who is designated as a Qualified Person with the ability and authority to verify the authenticity and validity of this data. All samples were analyzed by either Chemex Laboratories Ltd. of Mississauga, Ontario or SGS XRAL Laboratories of Red Lake, Ontario.

Goldcorp's Red Lake Mine is believed to be the richest gold mine in the world. The company is in excellent financial condition, with no debt and positive free cash flow and earnings. Goldcorp is North America's largest unhedged gold company, which allows its shareholders to participate fully in a rising gold price environment. Goldcorp's shares are listed on the New York and Toronto Stock Exchanges under the trading symbols of GG and G, respectively and its options trade on the American Stock Exchange (AMEX), the Chicago Board of Options Exchange (CBOE) and the Pacific Stock Exchange (PCX) in the United States and on the Montreal Exchange (MX) in Canada.

For further information, please contact:

Chris Bradbrook  
Vice President, Corporate Development  
Tel. (416) 865-0326  
Fax. (416) 361-5741

Corporate Office:  
145 King St. West, Suite 2700  
Toronto, Ontario  
Canada, M5H 1J8  
Website: [www.goldcorp.com](http://www.goldcorp.com)  
Email: [info@goldcorp.com](mailto:info@goldcorp.com)

**TABLE 1 - September 6, 2002**  
**RED LAKE MINE EXPLORATION UPDATE 28**  
**PREVIOUSLY UNRELEASED DRILL HOLE INTERSECTIONS**

Level Hole No.	Dip	Assay Interval (in feet)		Gold Assay		Gold Assay		Zone	Type
				Length (in feet)	Ounces per Ton (uncut)	Length (in metres)	Grams per Tonne (uncut)		
<b>DEEP HGZ EXTENSION</b>									
37L032AW	-33°	2488.0	2490.0	2.0	0.11	0.61	3.7	HW	EXP
		2496.0	2506.0	10.0	0.13	3.05	4.5	HW	EXP
		2542.0	2546.0	4.0	0.30	1.22	10.2	HW	EXP
		2562.0	2568.0	6.0	0.21	1.83	7.1	HW	EXP
		2584.0	2586.0	2.0	0.33	0.61	11.2	HW	EXP
		2602.0	2630.0	28.0	0.18	8.53	6.2	HW	EXP
		2638.0	2650.0	12.0	0.89	3.66	30.5	HWA	EXP
		2666.0	2670.0	4.0	0.11	1.22	3.7	X	EXP
37L032BW	-32°	2694.0	2698.0	4.0	1.85	1.22	63.4	X	EXP
		2756.0	2826.0	70.0	10.80	21.34	370.3	HW5	EXP
34L1052	-57°	1885.0	1887.0	2.0	0.25	0.61	8.6	FW	EXP
		2381.6	2388.2	6.6	0.12	2.01	4.1	HW	EXP
34L1053	-56°	1644.0	1646.0	2.0	0.38	0.61	13.0	FW3	EXP
34L1054	-59°	1598.0	1603.0	5.0	0.62	1.52	21.3	FW4	EXP
34L1054	-59°	1810.7	1814.0	3.3	0.76	1.01	26.1	FW4	EXP
		1837.0	1840.0	3.0	0.62	0.91	21.3	FW4B	EXP

**HIGH GRADE ZONE DELINEATION BELOW 37 LEVEL**

37L231	-36°	148.0	160.0	12.0	1.93	3.66	66.2	HW5	DEL
37L232	-13°	161.1	165.0	3.9	0.80	1.19	27.4	HW5	DEL
		368.5	373.0	4.5	50.29	1.37	1724.2	FW	DEL
37L233	-37°	131.8	139.1	7.3	1.18	2.23	40.6	HW5	DEL
		216.9	220.2	3.3	1.27	1.01	43.4	HWA	DEL
37L235	-29°	no significant results							DEL
37L243	-27°	189.9	195.7	5.8	7.64	1.77	262.0	HW5	DEL
37L244	-36°	178.0	181.3	3.3	0.61	1.01	20.9	HW5	DEL
		275.7	281.0	5.3	1.48	1.62	50.7	HWA	DEL
37L247	-67°	256.2	264.2	8.0	36.69	2.44	1257.9	HWA	DEL
37L248	-76°	307.0	309.0	2.0	0.42	0.61	14.4	HWA	DEL
37L249	-80°	no significant results							DEL
37L250	-8°	177.0	201.0	24.0	11.20	7.32	384.0	HW5	DEL
37L251	-12°	174.4	180.2	5.8	0.48	1.77	16.5	HW5	DEL
		418.8	423.2	4.4	20.04	1.34	687.1	X	DEL
		441.8	443.3	1.5	7.78	0.46	266.6	FW	DEL
37L252	-24°	no significant results							DEL
37L253	-29°	no significant results							DEL
37L254	-39°	no significant results							DEL
37L255	-47°	229.2	232.8	3.6	0.12	1.10	4.1	HWA	DEL
37L256	-56°	232.5	239.0	6.5	0.53	1.98	18.2	HWA	DEL
		252.2	254.3	2.1	0.47	0.64	16.1	X	DEL
37L257	-67°	236.1	240.1	4.0	3.32	1.22	113.8	HWA	DEL
37L258	-10°	451.8	466.0	14.2	2.78	4.33	95.3	HW5	DEL
37L259	-16°	430.0	434.0	4.0	2.41	1.22	82.7	HW5	DEL
		517.6	525.6	8.0	10.51	2.44	360.3	HWA	DEL
37L260	-23°	398.1	407.2	9.1	23.09	2.77	791.7	HW5	DEL
37L261	-29°	381.7	389.6	7.9	2.63	2.41	90.2	HW5	DEL
		472.3	475.2	2.9	1.49	0.88	51.1	HWA	DEL
37L262	-38°	no significant results							DEL
37L263	-45°	428.3	433.5	5.2	3.32	1.58	113.9	HWA	DEL
37L264	-57°	446.1	449.5	3.4	0.38	1.04	13.1	HWA	DEL
37L265	-65°	no significant results							DEL
37L270	-6°	no significant results							DEL

Level Hole No.	Dip	Assay Interval (in feet)		Gold Assay		Gold Assay		Zone	Type	
				Length (in feet)	Ounces per Ton (uncut)	Length (in metres)	Grams per Tonne (uncut)			
37L271	-17°	451.5	459.5	8.0	3.38	2.44	116.0	HW5	DEL	
		538.2	546.2	8.0	9.12	2.44	312.5	HWA	DEL	
37L272	-27°	414.9	425.4	10.5	10.32	3.20	353.8	HW5	DEL	
37L273	-35°	490.5	505.8	15.3	3.34	4.66	114.6	HWA	DEL	
37L274	-44°	no significant results								DEL
37L275	-59°	485.9	488.1	2.2	0.51	0.67	17.4	HWA	DEL	
37L276	12°	43.0	45.0	2.0	0.23	0.61	7.9	X	DEL	
37L280	-16°	no significant results								DEL
37L281	-30°	448.0	451.0	3.0	8.07	0.91	276.7	X	DEL	
		467.5	483.5	16.0	7.09	4.88	243.1	HW5	DEL	
		497.0	498.0	1.0	0.76	0.30	26.1	X	DEL	
		551.7	555.0	3.3	0.34	1.01	11.5	HWA	DEL	
37L282	-38°	598.4	601.7	3.3	0.67	1.01	23.0	EW	DEL	
		449.2	452.0	2.8	7.20	0.85	246.9	HW5	DEL	
		531.0	536.0	5.0	22.86	1.52	783.8	HWA	DEL	
37L283	-48°	no significant results								DEL
37L284	-56°	no significant results								DEL
37L287	-17°	no significant results								DEL
37L288	-24°	no significant results								DEL
37L289	-33°	499.8	518.1	18.3	5.78	5.58	198.2	HW5	DEL	
		526.2	528.1	1.9	0.66	0.58	22.7	X	DEL	
		585.9	590.5	4.6	2.68	1.40	91.9	HWA	DEL	
37L290	-43°	486.8	496.0	9.2	11.46	2.80	392.9	HW5	DEL	
37L291	-70°	599.5	600.7	1.2	1.57	0.37	54.0	HWA	EXP	
37L299	-44°	542.3	551.2	8.9	1.54	2.71	52.8	HW5	DEL	
37L300	-49°	535.0	542.0	7.0	7.79	2.13	267.1	HW5	DEL	
37L301	-55°	544.5	545.5	1.0	3.49	0.30	119.7	HW5	EXP	
		591.0	594.8	3.8	4.18	1.16	143.3	HWA	EXP	
37L307	-55°	583.6	586.5	2.9	1.95	0.88	66.9	HW5	EXP	
		614.7	620.4	5.7	57.83	1.74	1982.7	HWA	EXP	

#### FAR EAST ZONE

GC02-001	-80°	no significant results								EXP
GC02-001C	-80°	4057.0	4063.0	6.0	0.16	1.83	5.5	X	EXP	
		4337.0	4351.0	14.0	0.05	4.27	1.7	ESC	EXP	
		4392.5	4405.0	12.5	0.03	3.81	1.1	ESC	EXP	
GC02-001D	-80°	no significant results								EXP
GC02-001E	-80°	no significant results								EXP
GC02-002	-79°	no significant results								EXP
GC02-003	-82°	no significant results								EXP
16L1170	-9°	2037.5	2044.8	7.3	0.26	2.23	8.9	HW	EXP	
16L1175	-45°	527.0	531.0	4.0	0.32	1.22	10.9	ESC	EXP	
		558.0	561.0	3.0	0.12	0.91	4.2	ESC	EXP	
		585.0	602.0	17.0	0.16	5.18	5.5	ESC	EXP	
		613.0	628.0	15.0	0.41	4.57	14.1	ESC	EXP	
		635.0	639.0	4.0	0.18	1.22	6.2	ESC	EXP	
16L1178	-15°	672.0	675.0	3.0	0.25	0.91	8.5	ESC	EXP	
		no significant results								EXP
16L1179	-15°	642.4	644.2	1.8	0.17	0.55	5.8	HW	EXP	
16L1180	15°	no significant results								EXP
16L1181	-15°	no significant results								EXP
16L1188	33°	782.5	820.0	37.5	0.34	11.43	11.7	ESC	EXP	
34L1072	-21°	no significant results								EXP
34L1073	-46°	no significant results								EXP
34L1074	-67°	1354.5	1357.5	3.0	0.17	0.91	6.0	ESC	EXP	
34L1084	-15°	916.2	917.2	1.0	0.16	0.30	5.5	ESC	EXP	
34L1085	-35°	1170.0	1175.0	5.0	0.69	1.52	23.7	ESC	EXP	
		1222.6	1227.5	4.9	0.43	1.49	14.7	ESC	EXP	
34L1086	-53°	1342.0	1368.0	26.0	1.84	7.92	63.0	ESC	EXP	

Level Hole No.	Dip	Assay Interval (in feet)		Gold Assay		Gold Assay		Zone	Type
				Length (in feet)	Ounces per Ton (uncut)	Length (in metres)	Grams per Tonne (uncut)		
34L1088	0°			no significant results					EXP
34L1089	-23°	1238.0	1245.6	7.6	0.16	2.32	5.5	ESC	EXP
		1268.5	1271.0	2.5	0.34	0.76	11.7	ESC	EXP
34L1090	-45°			no significant results					EXP

#### DEEP SULPHIDE EXTENSION

30L1298	12°	68.0	71.0	3.0	0.12	0.91	4.1	ESC	EXP
		434.6	436.1	1.5	0.10	0.46	3.5	FW	EXP
31L488	-19°	1111.9	1122.7	10.8	0.16	3.29	5.5	ESC	DEL
31L489	-9°	431.5	434.0	2.5	0.16	0.76	5.5	ESC	DEL
31L490	-16°	507.7	511.7	4.0	0.13	1.22	4.6	FW4	DEL
		640.5	643.0	2.5	0.21	0.76	7.3	ESC	DEL
31L491	-32°	520.5	522.0	1.5	0.44	0.46	15.1	X	DEL
		528.0	532.0	4.0	0.25	1.22	8.5	ESC	DEL
		544.0	545.6	1.6	0.58	0.49	20.0	X	DEL
		610.7	619.1	8.4	0.36	2.56	12.3	ESC	DEL
31L492	-11°	618.0	624.0	6.0	0.70	1.83	24.0	ESC	DEL
31L493	-26°	586.0	607.0	21.0	0.19	6.40	6.5	ESC	EXP
31L501	-23°	507.5	510.0	2.5	0.29	0.76	9.9	FW	EXP
		1040.0	1044.4	4.4	0.24	1.34	8.2	ESC	EXP
		1080.9	1092.4	11.5	0.26	3.51	8.9	ESC	EXP
34L1018	-70°	442.0	445.4	3.4	0.13	1.04	4.5	ESC	EXP
		607.4	608.4	1.0	0.36	0.30	12.3	ESC	EXP
		810.3	812.3	2.0	0.16	0.61	5.5	ESC	EXP
		971.0	978.0	7.0	1.98	2.13	67.9	ESC	EXP
34L1052	-57°	1897.0	1905.0	8.0	0.16	2.44	5.4	ESC	EXP
34L1054	-59°	2165.0	2168.0	3.0	0.33	0.91	11.2	ESC	EXP
34L1058	-40°	583.0	586.0	3.0	0.21	0.91	7.2	ESC	EXP
34L1061	-35°			no significant results					EXP
34L1065	-20°			no significant results					EXP
34L1066	-25°			no significant results					EXP
34L1067	-10°			no significant results					EXP
34L1069	0°			no significant results					EXP
34L1070	-30°			no significant results					EXP
34L1075A	-19°			no significant results					EXP
34L1082	-15°	1310.0	1313.0	3.0	0.40	0.91	13.6	HW7	EXP
		1380.0	1384.0	4.0	0.17	1.22	5.8	X	EXP
37L245	-47°	1040.2	1042.2	2.0	0.28	0.61	9.6	ESC	EXP
37L275	-59°	1322.5	1332.5	10.0	0.23	3.05	7.8	ESC	DEL

#### HIGH GRADE ZONE DEFINITION AND DELINEATION (ABOVE 37 LEVEL)

30L1302	-13°	86.6	94.2	7.6	0.17	2.32	5.8	MAIN	DEL
30L1308	6°	40.0	43.0	3.0	0.59	0.91	20.2	FW3	DEL
30L1309	-2°	327.0	343.0	16.0	1.38	4.88	47.3	MAIN	DEL
30L1310	2°	39.5	43.4	3.9	1.93	1.19	66.2	FW3	DEL
		317.5	325.5	8.0	1.23	2.44	42.2	MAINA	DEL
31L479	49°	44.2	46.2	2.0	1.86	0.61	63.8	MAIN	DEF
31L481	-37°	167.5	173.5	6.0	0.28	1.83	9.5	HW	DEF
31L484	-22°	184.5	189.5	5.0	0.31	1.52	10.6	HWA	DEL
31L488	-19°	797.2	800.8	3.6	0.29	1.10	10.1	FW4	DEL
		924.9	927.0	2.1	0.26	0.64	8.9	X	DEL
31L489	-9°	114.4	120.1	5.7	0.12	1.74	4.1	FWA	DEL
31L492	-11°	143.5	146.0	2.5	0.53	0.76	18.1	FWA	DEL
31L493	-26°	132.9	147.0	14.1	0.38	4.30	13.2	FWA	DEL
		479.2	484.3	5.1	0.16	1.55	5.5	FW4	DEL
31L497	22°	74.2	76.8	2.6	0.65	0.79	22.3	X	DEL
31L498	16°	114.9	119.8	4.9	1.00	1.49	34.3	FWA	DEL
32L227	2°	198.2	206.0	7.8	0.59	2.38	20.1	FWA	DEF

Level Hole No.	Dip	Assay Interval (in feet)		Gold Assay		Gold Assay		Zone	Type
				Length (in feet)	Ounces per Ton (uncut)	Length (in metres)	Grams per Tonne (uncut)		
32L228	2°	19.9	25.9	6.0	0.44	1.83	15.0	MAIN	DEF
32L230	47°	94.3	106.3	12.0	20.31	3.66	696.3	MAINA	DEF
32L232	50°	30.0	32.0	2.0	0.89	0.61	30.5	X	DEF
		107.0	112.8	5.8	0.41	1.77	14.1	MAINA	DEF
32L233	35°	60.0	74.0	14.0	3.01	4.27	103.1	MAIN	DEF
32L234	52°	59.0	75.0	16.0	2.67	4.88	91.4	MAIN	DEF
32L235	51°	51.8	77.8	26.0	2.88	7.92	98.8	MAIN	DEF
32L236	38°	81.6	83.6	2.0	0.54	0.61	18.5	MAIN	DEF
32L247	26°	43.5	44.5	1.0	3.34	0.30	114.4	FW	DEF
32L251	8°	51.3	52.6	1.3	6.09	0.40	208.7	FW	DEF
32L253	0°	35.4	37.2	1.8	0.75	0.55	25.7	FW	DEF
34L1057	30°	342.0	356.0	14.0	0.14	4.27	4.8	FW	DEF
34L1061	-35°	820.0	832.0	12.0	0.77	3.66	26.4	FW4	DEL
34L1096	23°	154.0	159.0	5.0	0.92	1.52	31.5	FWB	DEF
		202.4	224.4	22.0	1.82	6.71	62.4	MAIN	DEF
34L1097	11°	217.0	227.0	10.0	34.03	3.05	1166.8	MAIN	DEF
34L1100	8°	145.6	147.6	2.0	0.94	0.61	32.1	FWC	DEF
		199.9	205.9	6.0	1.08	1.83	37.0	FWA	DEF
34L1101	44°	205.7	209.7	4.0	4.22	1.22	144.6	MAIN	DEF
34L1102	9°	109.0	132.0	23.0	1.29	7.01	44.2	X	DEF
		146.8	155.6	8.8	5.84	2.68	200.1	FWC	DEF
		168.0	172.0	4.0	1.04	1.22	35.7	FWB	DEF
34L1103	22°	68.5	70.5	2.0	1.98	0.61	67.8	X	DEF
		197.3	211.3	14.0	2.15	4.27	73.6	MAIN	DEF
34L1104	28°	205.2	207.4	2.2	9.61	0.67	329.5	MAIN	DEF
34L1106	8°	226.7	231.0	4.3	5.24	1.31	179.7	MAIN	DEL
34L1110	-4°	127.0	141.0	14.0	0.37	4.27	12.8	FWD	DEF
		149.1	151.0	1.9	0.48	0.58	16.5	X	DEF
		166.4	170.5	4.1	0.62	1.25	21.1	FWC	DEF
34L1111	-15°	187.7	195.7	8.0	2.71	2.44	92.9	FWC	DEL
36L034	-4°	173.8	178.0	4.2	55.39	1.28	1899.1	EW	DEF
36L039	13°	12.0	15.0	3.0	32.59	0.91	1117.4	FW	DEF
36L040	23°	21.0	26.0	5.0	0.53	1.52	18.2	FW	DEL
37L267	3°	186.2	195.5	9.3	3.45	2.83	118.1	MAIN	DEL
37L268	14°	220.7	229.0	8.3	0.16	2.53	5.6	HW	DEL
		253.0	260.0	7.0	0.37	2.13	12.7	EW	DEL
		300.0	308.0	8.0	1.60	2.44	54.9	HWA	DEL
37L269	6°	232.0	240.0	8.0	5.03	2.44	172.5	EW	DEF
37L295	32°	62.4	69.4	7.0	2.15	2.13	73.9	HW	DEF
37L296	37°	80.0	86.1	6.1	7.71	1.86	264.3	HW	DEF
37L297	47°	95.0	107.0	12.0	1.02	3.66	35.0	EW	DEF
37L298	54°	73.5	77.5	4.0	0.60	1.22	20.6	HW	DEF
		116.5	126.5	10.0	3.54	3.05	121.3	EW	DEF
FW	Footwall Zone			1 ounce per ton =		34.2857 grams per tonne			
MAIN	Main Zone			1 foot =		0.3048 metres			
HW	Hanging Wall Zone			X		Cross Structure			
ESC	Sulphide Zone			EXP		Exploration			
DEF	Definition			DEL		Delineation			

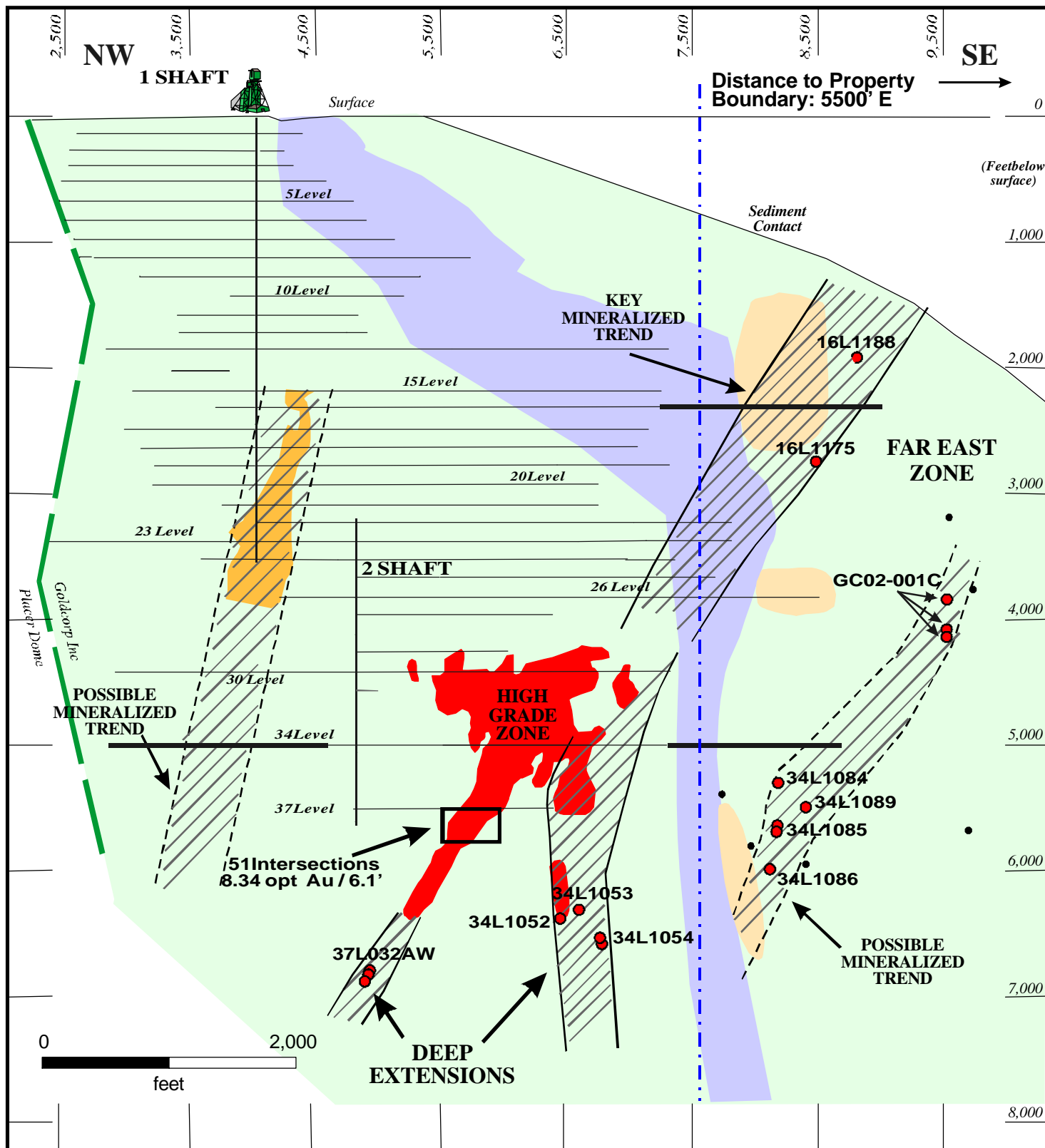

**LEGEND:**

HighGradeZone	RecentDevelopment
EandFZones	ExistingDevelopment
MineralizedTrend	FutureDevelopment
EasternUltramafic	HighlightedNew DrillHole
BasicVolcanics	NonSignificant Intersections
Previous Intersections	<b>34L1054</b> DrillHoleNumber
PropertyBoundary	





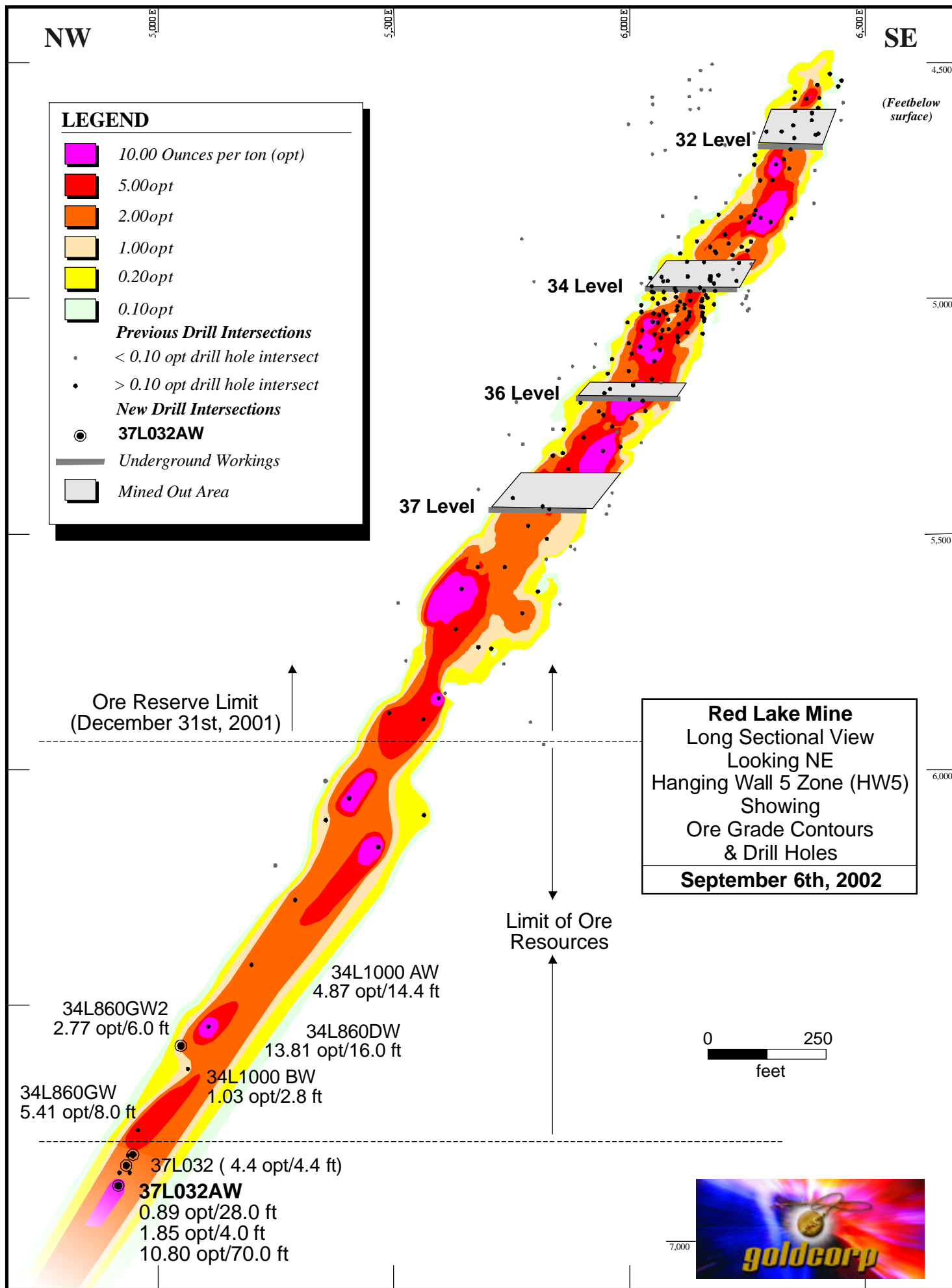

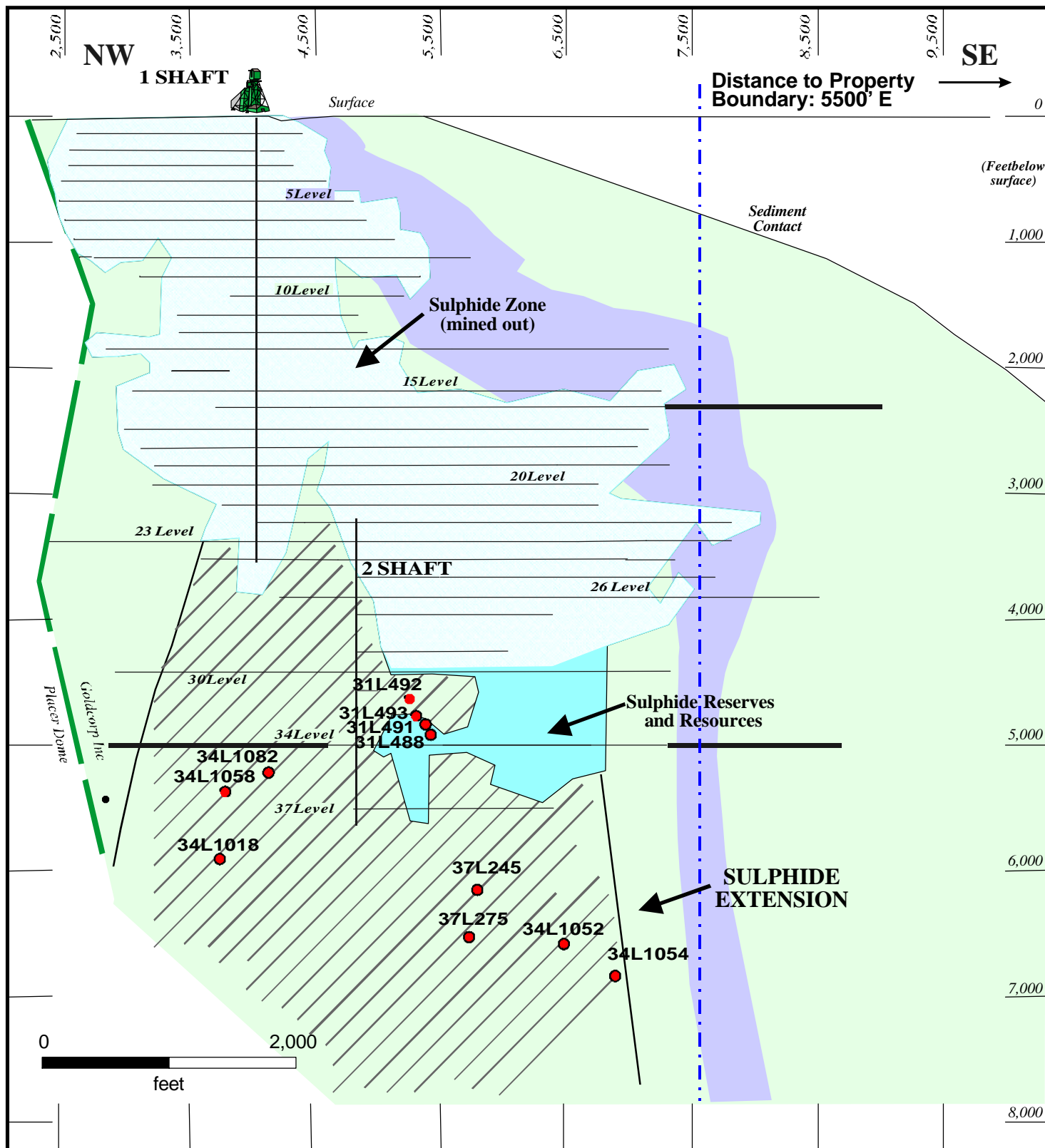



**Red Lake Mine**  
 Schematic Longitudinal  
 Showing High Grade Extension  
 and Far East Target Areas  
**September 6th, 2002**

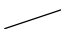



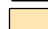

**LEGEND:**

- |   |                        |   |                              |
|---|------------------------|---|------------------------------|
|  | HighGradeZone          |  | RecentDevelopment            |
|  | EandFZones             |  | ExistingDevelopment          |
|  | MineralizedTrend       |  | FutureDevelopment            |
|  | EasternUltramafic      |  | HighlightedNew DrillHole     |
|  | BasicVolcanics         |  | NonSignificant Intersections |
|  | Previous Intersections |   |                              |
|  | PropertyBoundary       |   |                              |
- 34L1054 DrillHoleNumber

**Red Lake Mine**  
Schematic Longitudinal  
Showing Sulphide Extension  
Target Area

**September 6th, 2002**



### Red Lake - Campbell Mines Schematic Longitudinal Showing Mineralized Trends

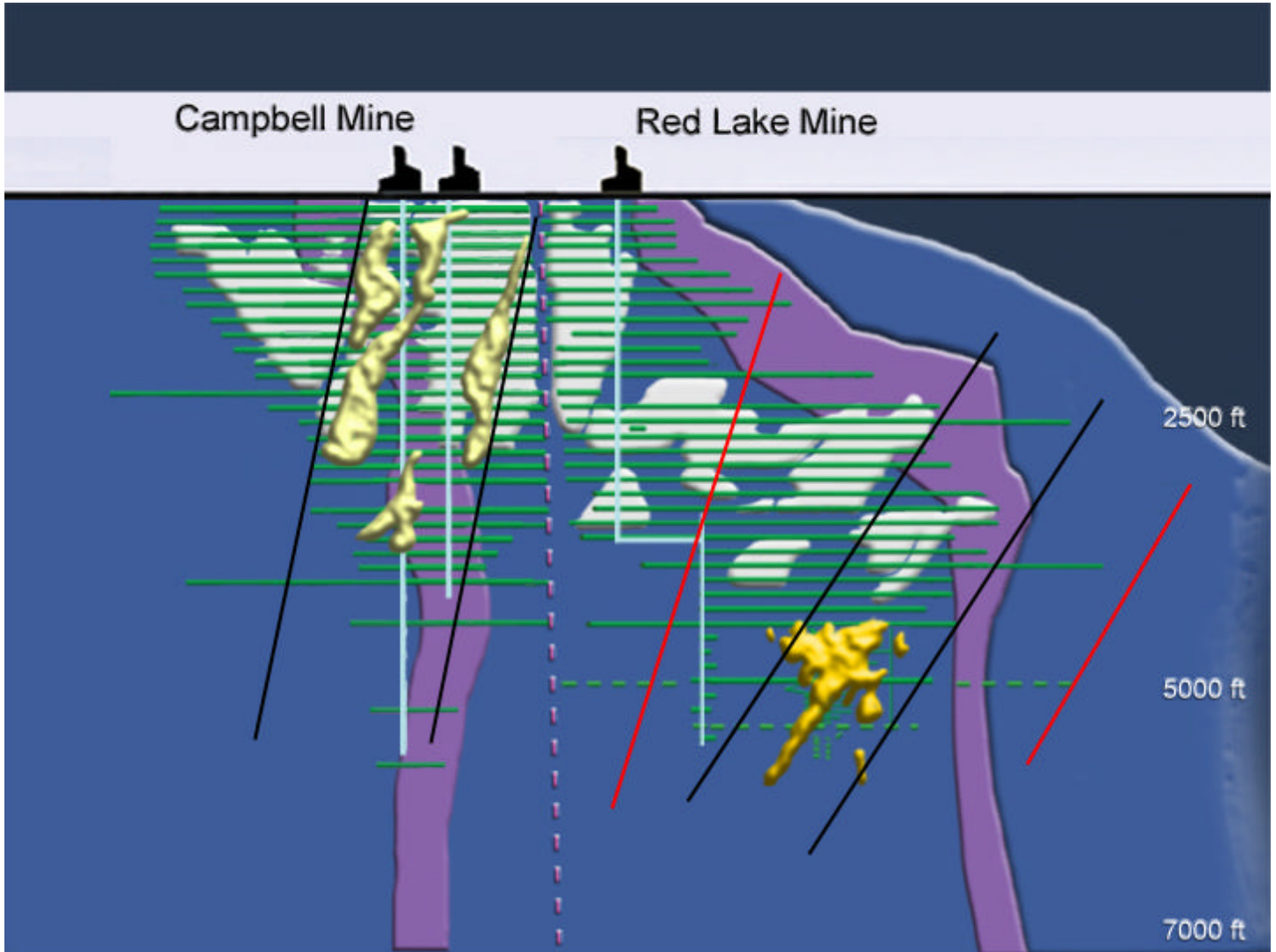

**LEGEND:**

- |  |   |
|--|---|
|  HighGradeZone  |  Key MineralizedTrend      |
|  Ultramafic     |  PotentialMineralizedTrend |
|  BasicVolcanics |   |

September 6th, 2002

